

EN Fitting Instructions for Basic Carrier

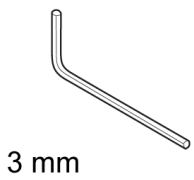

x 1

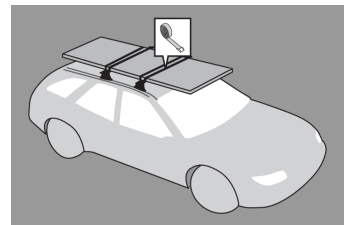
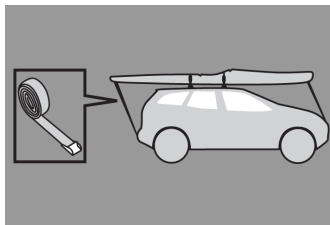
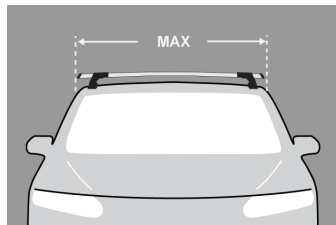
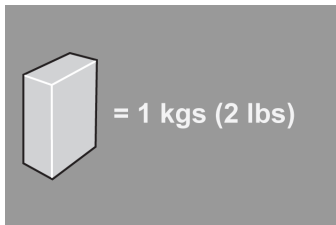

x 6

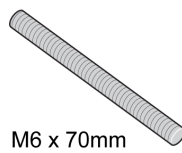

x 4

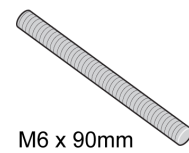

x 2



x 6

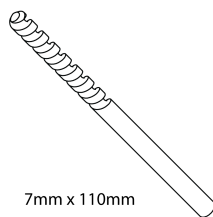

x 1

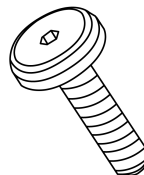

x 6

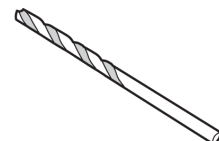

x 1

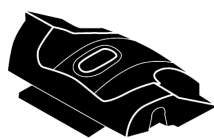

11-02-233

x 6

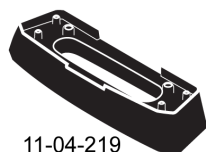

11-04-219

x 2



11-04-222

x 1



11-04-223

x 1

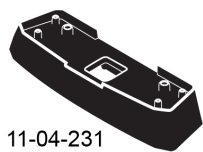

11-04-231

x 1

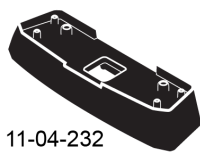

11-04-232

x 1



MAX kgs (lbs)

🚩 W/P WHD

Land Rover

- Range Rover Sport (2 BAR), 5dr SUV 13-+
- Range Rover Sport (2 BAR), 5dr SUV 13-+
- Range Rover Sport (2 BAR), 5dr SUV 13-+
- Range Rover Sport (2 BAR), 5dr SUV 13-+
- Range Rover Sport (2 BAR), 5dr SUV 13-+
- Range Rover Sport (3 BAR), 5dr SUV 13-+
- Range Rover Sport (3 BAR), 5dr SUV 13-+
- Range Rover Sport (3 BAR), 5dr SUV 13-+
- Range Rover Sport (3 BAR), 5dr SUV 13-+
- Range Rover Sport (3 BAR), 5dr SUV 13-+

🚩	W/P	WHD
NZ	75 kgs (165 lbs)	75 kgs (165 lbs)
AU	75 kgs (165 lbs)	75 kgs (165 lbs)
EU	75 kgs (165 lbs)	75 kgs (165 lbs)
ZA	75 kgs (165 lbs)	75 kgs (165 lbs)
CN	75 kgs (165 lbs)	75 kgs (165 lbs)
AU	75 kgs (165 lbs)	75 kgs (165 lbs)
CN	75 kgs (165 lbs)	75 kgs (165 lbs)
EU	75 kgs (165 lbs)	75 kgs (165 lbs)
NZ	75 kgs (165 lbs)	75 kgs (165 lbs)
ZA	75 kgs (165 lbs)	75 kgs (165 lbs)

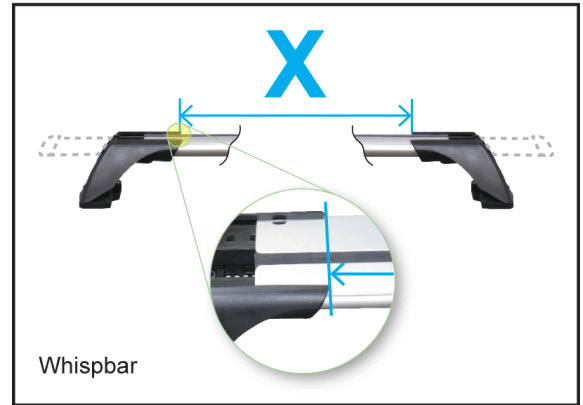
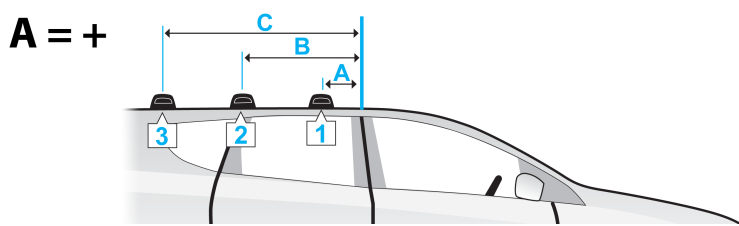
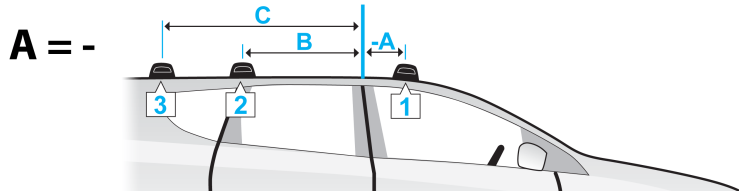

	A	B	C	X		
				1	2	3
Range Rover Sport (2 BAR), 5dr SUV 13+ (NZ)	-230mm -9 -1/16ths"	450mm 17 3/4ths"	-	1056mm 41 9/16ths"	1056mm 41 9/16ths"	-
Range Rover Sport (2 BAR), 5dr SUV 13+ (AU)	-230mm -9 -1/16ths"	450mm 17 3/4ths"	-	1056mm 41 9/16ths"	1056mm 41 9/16ths"	-
Range Rover Sport (2 BAR), 5dr SUV 13+ (EU)	-230mm -9 -1/16ths"	450mm 17 3/4ths"	-	1056mm 41 9/16ths"	1056mm 41 9/16ths"	-
Range Rover Sport (2 BAR), 5dr SUV 13+ (ZA)	-230mm -9 -1/16ths"	450mm 17 3/4ths"	-	1056mm 41 9/16ths"	1056mm 41 9/16ths"	-
Range Rover Sport (2 BAR), 5dr SUV 13+ (CN)	-230mm -9 -1/16ths"	450mm 17 3/4ths"	-	1056mm 41 9/16ths"	1056mm 41 9/16ths"	-
Range Rover Sport (3 BAR), 5dr SUV 13+ (AU)	-230mm -9 -1/16ths"	450mm 17 3/4ths"	1285mm 50 9/16ths"	1056mm 41 9/16ths"	1056mm 41 9/16ths"	1028mm 40 1/2ths"
Range Rover Sport (3 BAR), 5dr SUV 13+ (CN)	-230mm -9 -1/16ths"	450mm 17 3/4ths"	1285mm 50 9/16ths"	1056mm 41 9/16ths"	1056mm 41 9/16ths"	1028mm 40 1/2ths"
Range Rover Sport (3 BAR), 5dr SUV 13+ (EU)	-230mm -9 -1/16ths"	450mm 17 3/4ths"	1285mm 50 9/16ths"	1056mm 41 9/16ths"	1056mm 41 9/16ths"	1028mm 40 1/2ths"
Range Rover Sport (3 BAR), 5dr SUV 13+ (NZ)	-230mm -9 -1/16ths"	450mm 17 3/4ths"	1285mm 50 9/16ths"	1056mm 41 9/16ths"	1056mm 41 9/16ths"	1028mm 40 1/2ths"
Range Rover Sport (3 BAR), 5dr SUV 13+ (ZA)	-230mm -9 -1/16ths"	450mm 17 3/4ths"	1285mm 50 9/16ths"	1056mm 41 9/16ths"	1056mm 41 9/16ths"	1028mm 40 1/2ths"

First Time Installation



- Remove parts from inside the package and check. Contact your dealer if any parts are missing or damaged.



- This kit fits type A, B, C and D.
- These instructions show type A crossbar fitted. They also apply to type B, C and D.



- Use keys to remove covers.



- Use hex screwdriver to reverse adjusting screw 10 turns.



- Press adjusting screw and pull crossbar legs out. Refer to the crossbar instructions for crossbar adjustment method.
- Ensure each end of the crossbar is adjusted equally.

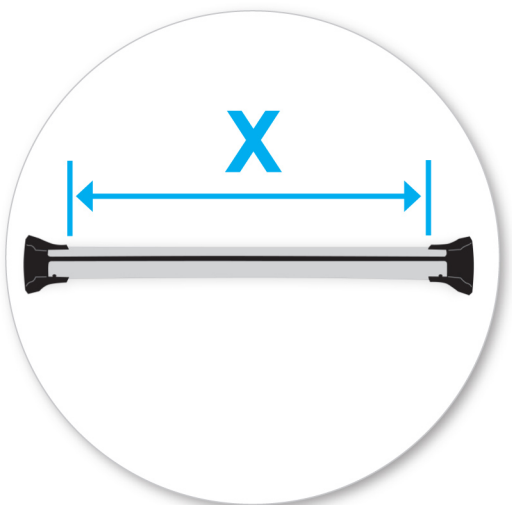

- Attaches to factory-fitted mounting points
- Please check the front of this manual for information relating specifically to your vehicle.
- Adjust crossbar in or out to suit vehicle. Refer to the crossbar instructions for crossbar adjustment.



- Tighten adjusting screw to 2 Nm (1.5 ft lb) hand tight.

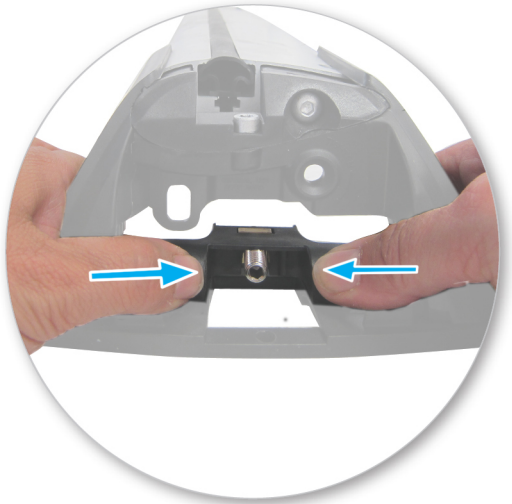

- Remove plastic clamp block by gripping bar leg with fingers and push firmly with thumbs until clamp block drops out behind leg.



- Select plastic internal block (from fitting kit) and insert into foot.
- Repeat for all legs.

Fitment



- Lift and pull ditch moulding back towards you and remove from the vehicle.



- Remove retaining clips from 2nd and 4th position for 2 bar system.
- Remove retaining clips from 2nd, 4th and 6th position for 3 bar system.
- Repeat both sides.

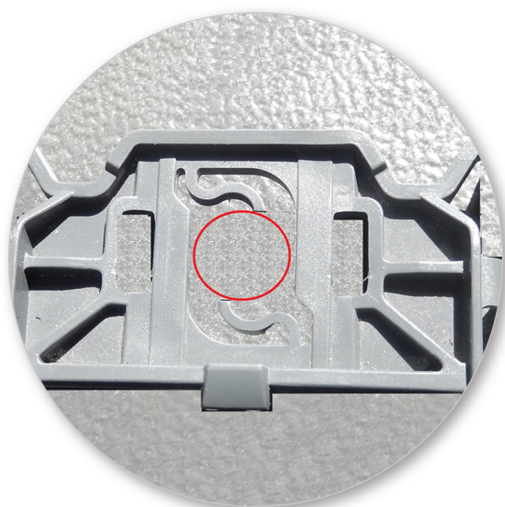

- Remove centre of retaining clip by twisting.
- Repeat for all six positions.



- Use drill bit supplied, to drill holes in marked positions on ditch mould.



- Replace retaining clips into ditch mould.



- Re-install rubber ditch mould back into roof channel and click into place.

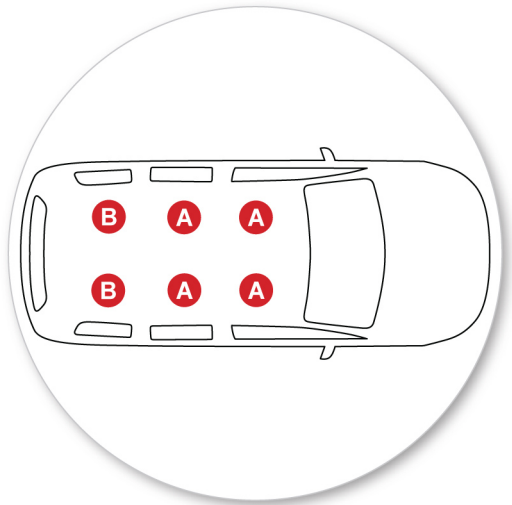

- Letters refer to the part numbers stamped on clamps.
- Grubscrew Part Number: 2 bars only
A = 70mm
- Grubscrew Part Number: 3 bars only
A = 70mm
B = 90mm



- Select grubscrews and screw into the vehicle's fixed points.
- Do not over tighten.
- Repeat for all positions.



- Refer to the underside of the pad for the part number.

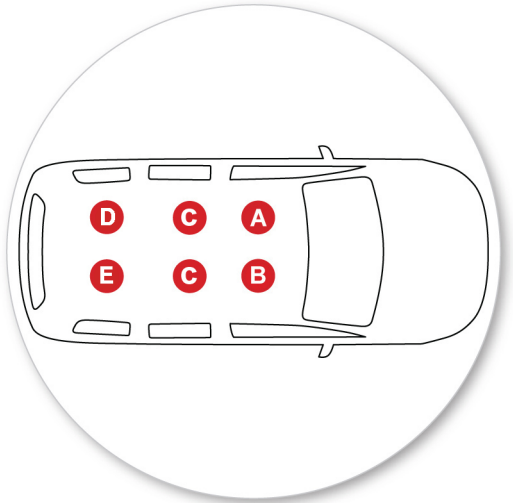

- Letters refer to the pad part numbers and position.

- Pad Part Number: 2 bars only

A = 223

B = 222

C = 219

- Pad Part Number: 3 bars only

A = 223

B = 222

C = 219

D = 231

E = 232



- Place crossbars on pads ensuring the pads fit into the holes underneath the foot and the grub screw passes through the hole in the foot.

- Repeat for all positions.



- Tighten the plastic knob. The side with the nut showing should be facing up.



- Ensure the plastic knob is in the position shown when fully tightened.
- Repeat for all legs.



- Check crossbar is securely attached to the vehicle.
- Use keys to fit and lock covers

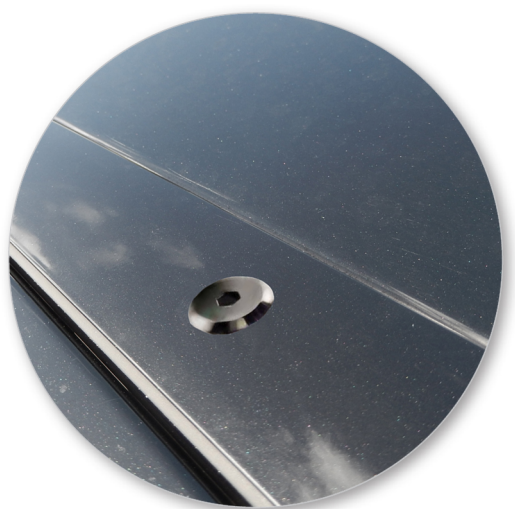

- If crossbars are removed, please install supplied cap screw nylon washer.

**CAUTION: Recheck all fasteners immediately after a load is applied to the crossbars.
Regularly check screws are tight.**

Maintenance

- Clean the car roof and surfaces of the product that will be in contact with the car roof.
- Follow the fitting instructions for fitting the product to your vehicle. Make sure all steps are carried out in order.
- Set crossbars a minimum distance of 700mm (27 1/2") apart where no other distance is specified in the fitting instructions. This is especially important when carrying long loads.
- Check unit is securely attached whenever you refit it to the vehicle. If the unit feels loose, refer to the fitting instructions and readjust.
- Some glass/panoramic roofs and radio antennae may not be able to be used when the product is fitted.
- Do not modify this product.
- Refer to the maximum permitted load capacity specified in the fitting instructions. Do not exceed the vehicle manufacturers roof load rating if it is lower than the maximum load capacity specified in the fitting instructions.
- Loads should not overhang the sides of the product and be evenly distributed with the lowest possible centre of gravity.
- Long loads should be secured with non-elastic straps to the front and rear of the vehicle.
- Objects with pointed ends (e.g. ski poles) should be carried with the pointed ends to the rear of the vehicle.
- Remove all loose or removable objects from the load prior to loading.
- Make sure all loads are securely fastened with non-elastic straps. Check regularly during longer journeys.
- A loaded roof rack system can alter the performance of your vehicle. Be especially aware of the effects of side winds, changing of direction, and braking performance. Avoid rapid acceleration and deceleration. Drive carefully.
- Note that the total height of the vehicle increases when upright loads are carried.
- Products should be locked during transport if they have locks fitted.

- Check and replace worn out or defective parts.
 - Keep the product clean and maintained.
 - Never drive into a car wash with the roof rack system fitted.
 - Lubricate locks and adjusting screws at regular intervals.
 - Remove the products from the vehicle when not in use. Make sure all loose parts are stored safely.
-

- Yakima Australia Pty Ltd
17 Hinkler Court
Brendale QLD 4500
AUSTRALIA

www.whispbar.com
www.whispbar.com.au
www.whispbar.co.nz
www.whispbar.co.uk
www.whispbar.co.za
www.whispbar.eu
www.whispbar.ca

3 YEAR WARRANTY

Technical Assistance or Replacement Parts: Contact your Prorack dealer or visit: www.prorackeurope.eu or email warranty@yakima.eu Monday through Friday, 7:00am to 5:00pm, PST

This 3 (three) year warranty covers all Prorack products* and rack components manufactured by Yakima Europe Coöperatief U.A. (YakimaEU), and is effective for as long as the original retail purchaser owns the product. This warranty terminates when the original retail purchaser sells or otherwise transfers the product to any other person. Subject to YakimaEU's inspection of the product, YakimaEU will remedy defects in materials and/or workmanship by repairing or replacing, at YakimaEU's option, the defective product without charge for parts or labor, subject to the limitations and exclusions described in this warranty. YakimaEU may elect, at its option, not to repair or replace a defective product, in which case YakimaEU will issue to the original retail purchaser, at YakimaEU's option, either a refund equal to the purchase price paid for the product, or a credit to be used toward the purchase of new Prorack products or rack components. This warranty does not cover problems caused by normal wear and tear (including, but not limited to, scratches, dents, or aesthetic oxidation of surfaces), accidents, unlawful vehicle operation, or modifications or repairs not performed or authorized by YakimaEU. In addition, this warranty does not cover problems resulting from conditions beyond YakimaEU's control including, but not limited to, theft, misuse, overloading, or failure to assemble, mount or use the product in accordance with YakimaEU's written instructions or guidelines included with the product or made available to the original retail purchaser. If a product is believed to be defective, the original retail purchaser should contact the Prorack dealer from whom it purchased the product, who will give the original retail purchaser instructions on how to proceed. If the original retail purchaser is unable to contact the Prorack dealer, or the dealer is not able to remedy the defect, the original retail purchaser should contact YakimaEU by e-mail at: warranty@yakima.eu for shipping instructions. Upon contacting YakimaEU directly, a YakimaEU technician will provide the original retail purchaser with appropriate instructions for returning the product to YakimaEU. The original retail purchaser will be responsible for the cost of mailing the product to YakimaEU. In order to receive any remedy under this warranty (either from a Prorack dealer, or from YakimaEU directly), proof of purchase in the form of an original purchase invoice or receipt is strictly required.

LIMITATION OF LIABILITY

REPAIR OR REPLACEMENT OF A DEFECTIVE PRODUCT, OR THE ISSUANCE OF A REFUND OR CREDIT (AS DETERMINED BY YAKIMAEU), IS THE ORIGINAL RETAIL PURCHASER'S EXCLUSIVE REMEDY UNDER THIS WARRANTY. DAMAGE OR INJURY TO THE ORIGINAL RETAIL PURCHASER, TO HIS OR HER VEHICLE, CARGO, OR PROPERTY, AND/OR TO ANY OTHER PERSON OR PROPERTY IS NOT COVERED BY THIS WARRANTY. THIS WARRANTY IS EXPRESSLY MADE IN LIEU OF ANY AND ALL OTHER EXPRESS WARRANTIES, WHETHER ORAL OR WRITTEN.

YAKIMAEU'S SOLE LIABILITY IS LIMITED TO THE REMEDY SET FORTH ABOVE. IN NO EVENT WILL YAKIMAEU BE LIABLE FOR ANY DIRECT, INDIRECT, CONSEQUENTIAL, INCIDENTAL, SPECIAL, EXEMPLARY, OR PUNITIVE DAMAGES OR FOR ANY OTHER DAMAGES OF ANY KIND OR NATURE (INCLUDING, BUT NOT LIMITED TO, LOST PROFITS OR LOST SALES). SOME STATES DO NOT ALLOW THE EXCLUSION OR LIMITATION OF INCIDENTAL OR CONSEQUENTIAL DAMAGES, SO THE ABOVE LIMITATIONS MAY NOT APPLY TO YOU. THIS WARRANTY GIVES YOU SPECIFIC LEGAL RIGHTS, AND YOU MAY ALSO HAVE OTHER RIGHTS WHICH VARY FROM STATE TO STATE.